

Axial lead devices are packed in accordance with EIA standard RS-296-D and specifications given below:

COMPONENT OUTLINE	COMPONENT PITCH A	INNER TAPE PITCH B*	CUMULATIVE PITCH TOLERANCE
	$\pm 0.5\text{mm} (.020\text{'})$	$\pm 1.5\text{mm} (.059\text{'})$	
DO-34/DO-35	5.0mm	52 mm	2.0mm/10pitch
R-1	5.0mm	52 mm	2.0mm/10pitch
A-405	5.0mm	52 mm	2.0mm/10pitch
DO-41	5.0mm	52 mm	2.0mm/10pitch
DO-15	5.0mm	52 mm	2.0mm/10pitch
R-3	5.0mm	52 mm	2.0mm/10pitch
DO-27/DO-201AE	10.0mm	52 mm	2.0mm/10pitch
R-6/R-6M	10.0mm	52 mm	2.0mm/10pitch

*INNER TAPE PITCH B 26mm for DO-34/DO-35/R-1/A-405 also available upon request.

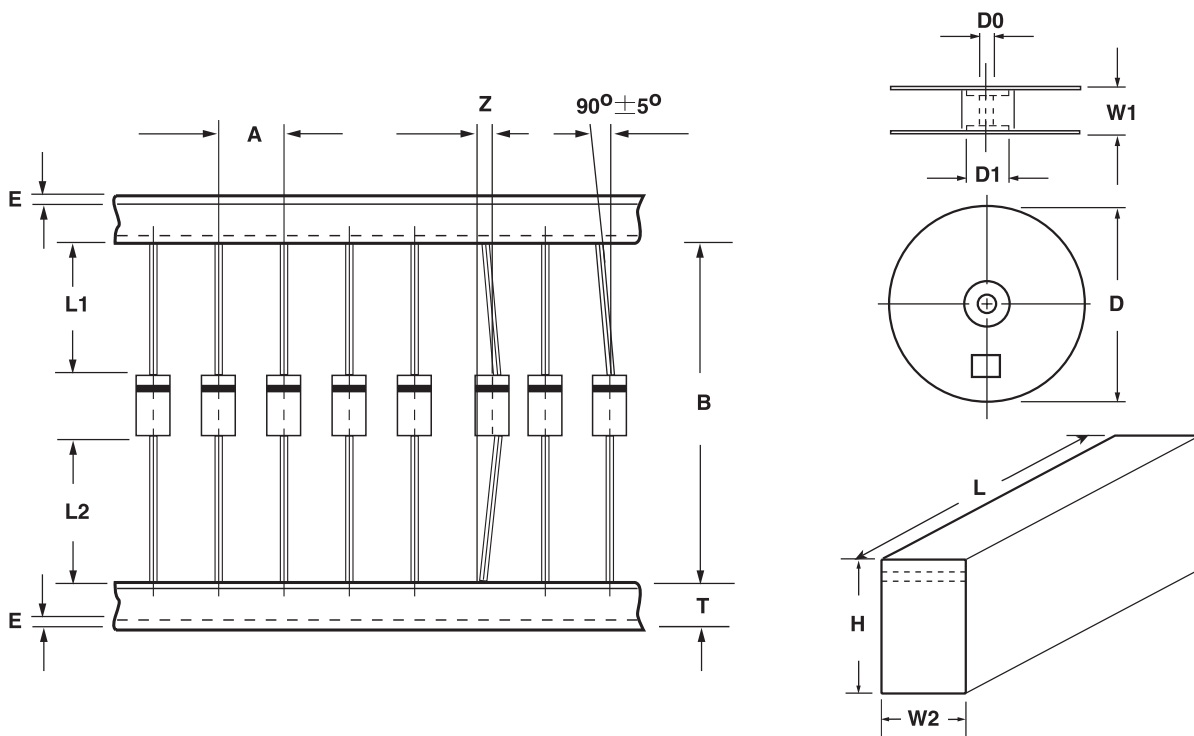

ITEM	SYMBOL	SPECIFICATIONS (mm)	SPECIFICATIONS (inch)
Component alignment	Z	1.2max.	0.048 max.
Tape width	T	6.0 ± 0.4	0.236 ± 0.016
Exposed adhesive	E	0.8 max.	0.032 max.
Body eccentricity	L1-L2	1.0max.	0.040 max.
Reel outside diameter	D	330	13
Reel inner diameter	D1	85.7 ± 0.3	3.375 ± 0.012
Feed hole diameter	D0	16.6 ± 0.4	0.655 ± 0.016
Reel width	W1	79.0 ± 1.0	3.110 ± 0.040
Box length	L	255.0 ± 5.0	10.04 ± 0.197
Box width	W2	78.0 ± 5.0	3.070 ± 0.197
Box height	H	95.0 ± 5.0	3.740 ± 0.197

NOTE: 1. Each component lead shall be sandwiched between tapes for a minimum of 3.2mm (0.126inch)

2. The reel width "W1" and the box width "W2" for 26mm taping are $50.0 \pm 1.0\text{mm}$ ($1.97 \pm 0.040\text{inch}$)